

Body Assembly

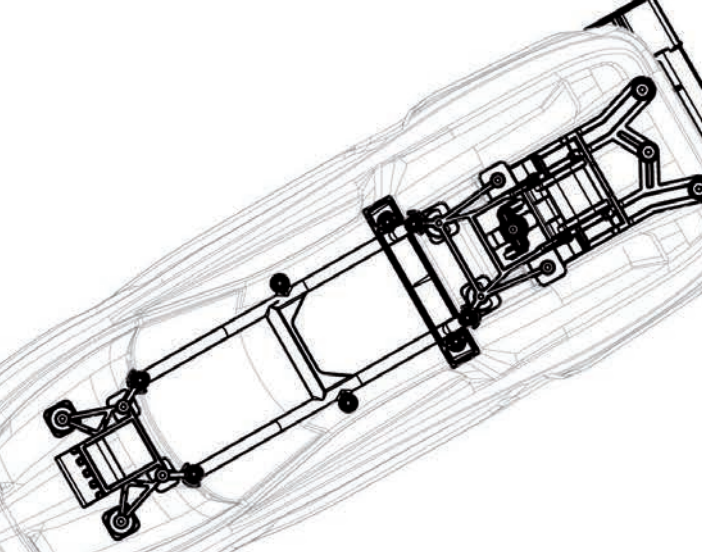

Completed Assembly (view from bottom)



This diagram shows the completed assembly from a bottom-up perspective. The chassis is clearly visible, with the suspension system and rear end components. The car's body is shown in a wireframe style, highlighting the internal structure and the placement of the chassis components.



See Parts List for a complete listing of optional accessories.

RUSTLER
4x4vxl
Chassis Assembly

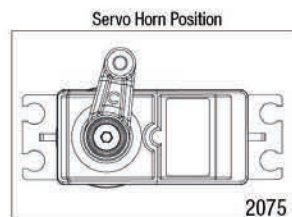

REV 180830-R02

[illegible]

Specifications on this page are subject to change without notice. Every attempt has been made to ensure the accuracy of this drawing; however, Traxxas cannot be held responsible for typographical or other errors.

RUSTLER
Front Assembly **4x4VXL**
BRUSHLESS

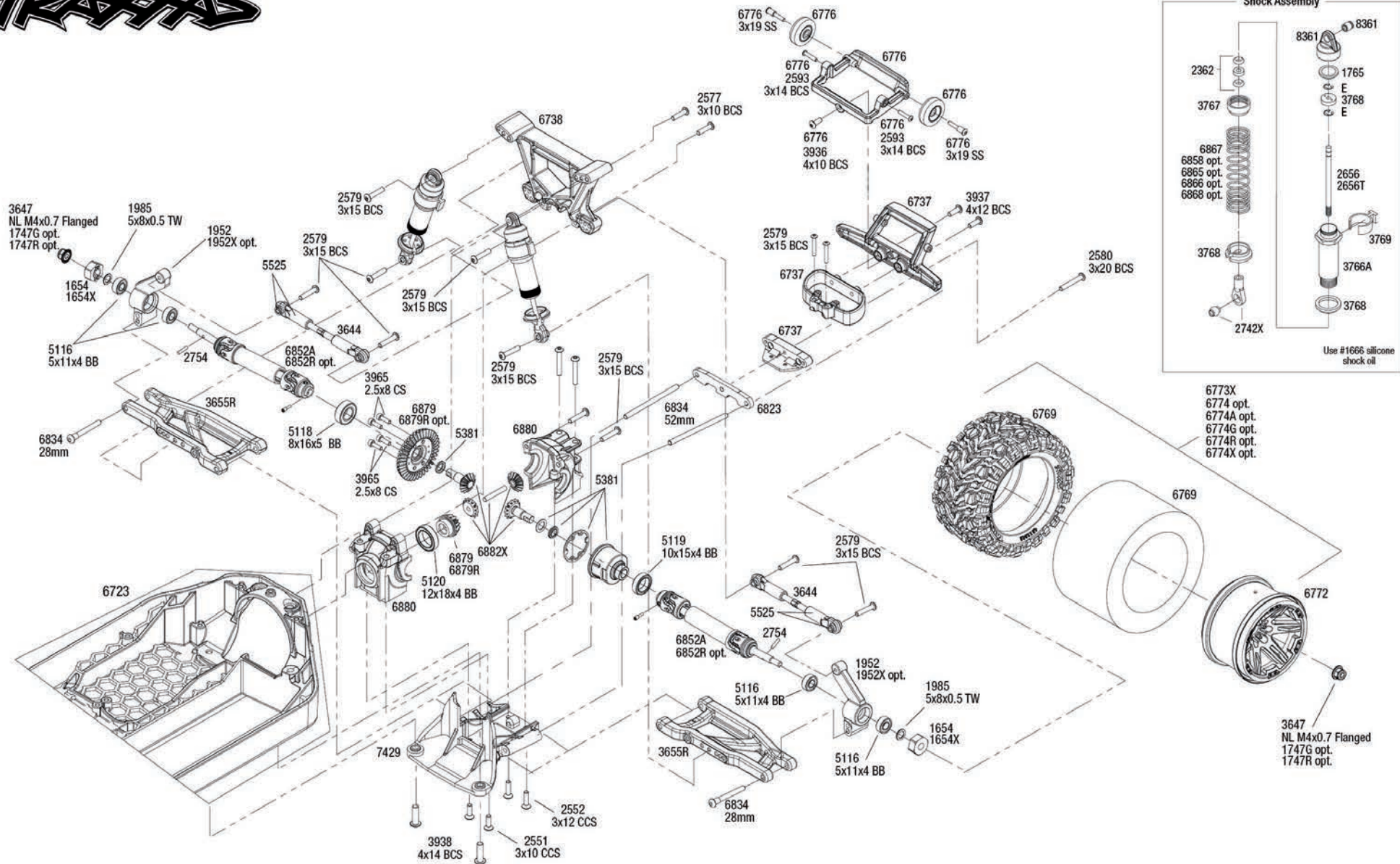

RUSTLER **4x4 VXL** **Rear Assembly** BRUSHLESS

See Parts List for a complete listing of optional accessories.

Specifications on this page are subject to change without notice. Every attempt has been made to ensure the accuracy of this drawing; however, Traxxas cannot be held responsible for typographical or other errors.

REV 180830-R02

RUSTLER 4x4vxl BRUSHLESS

Transmission Assembly

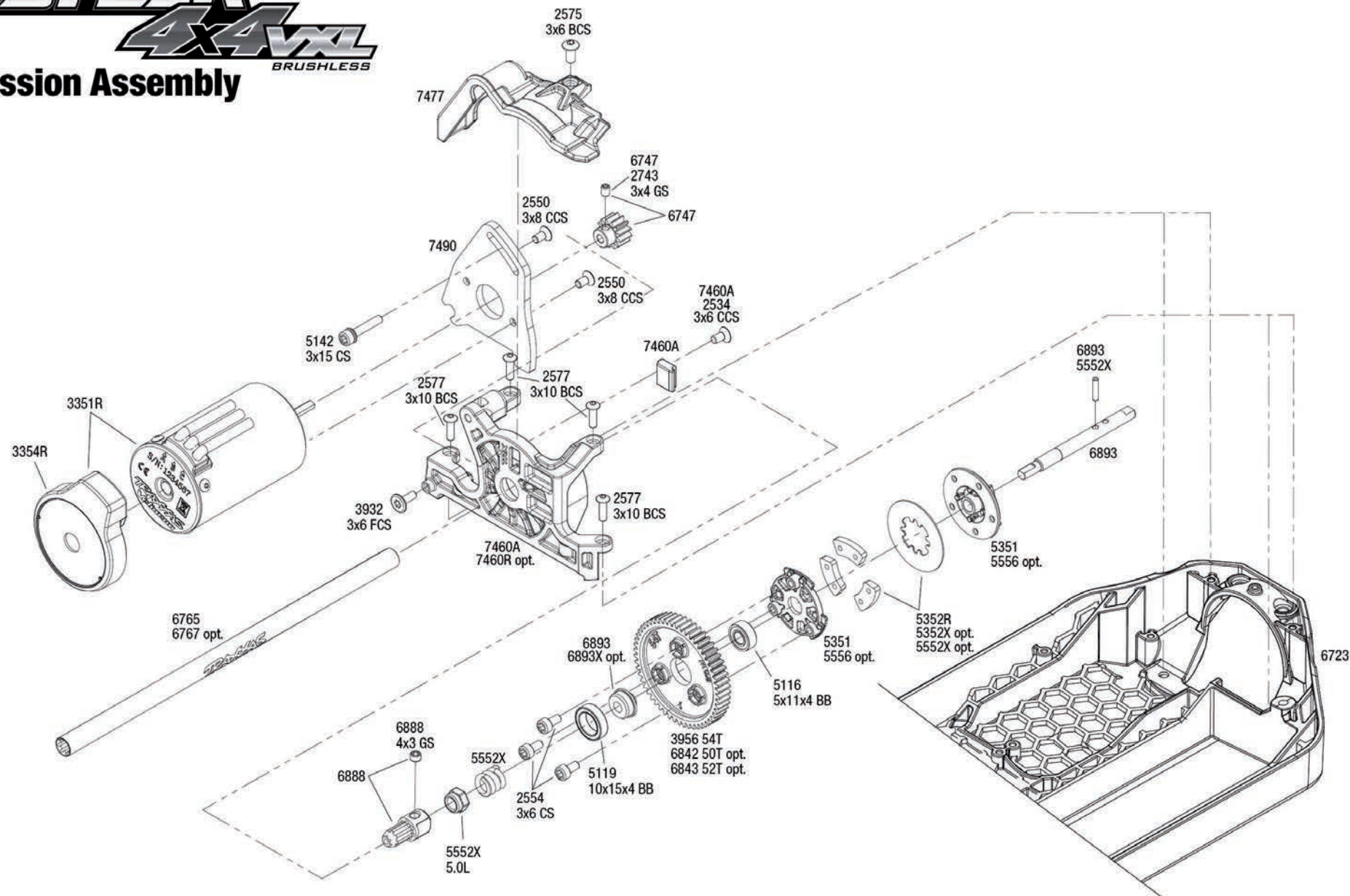

TRAXXAS

See Parts List for a complete listing of optional accessories.

REV 180830-R02
Specifications on this page are subject to change without notice. Every attempt has been made to ensure the accuracy of this drawing; however, Traxxas cannot be held responsible for typographical or other errors.

Driveshafts

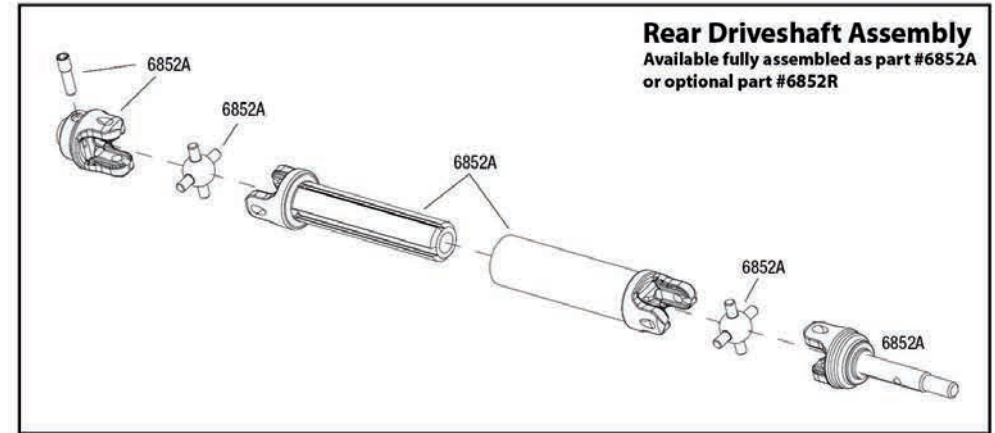
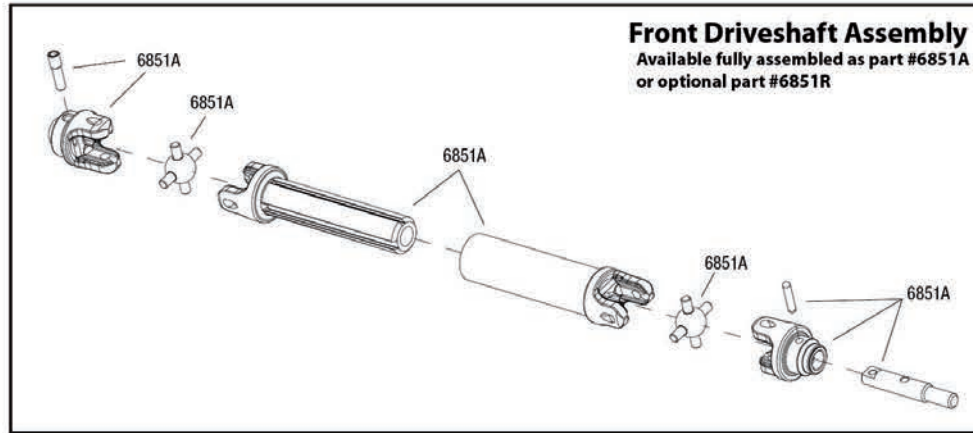

Modular Assembly

